

ULTRA FAUCETS

INSTALLATION

MODEL NUMBER

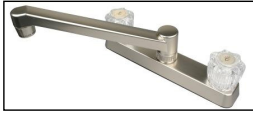

UF08X20



UF08X25

TOOLS YOU MIGHT NEED:

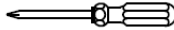

Phillips Screwdriver



Groove Joint Plier



Silicone Sealant



Adjustable Wrench



Teflon Tape



Hex Wrench

1 BEFORE PROCEEDING

WARNING: Read all the instructions before proceeding. We recommend calling a professional if you are uncertain about installing this product! This product should be installed in accordance with all local and state plumbing and building code requirements.

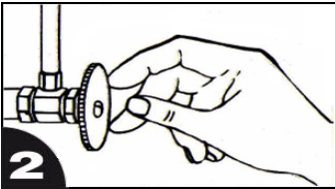

2 SHUT OFF WATER SUPPLY

Locate the water supply inlets and shut off both the hot and cold water supply valves. If you are replacing an existing faucet, remove the old faucet. Clean the sink surface thoroughly in preparation for the new faucet.

For model without spray, please skip to Step#5.

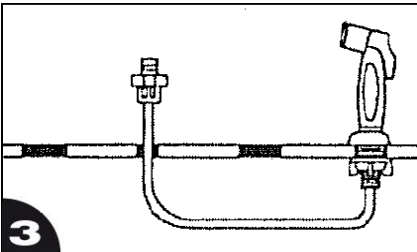

3 MOUNT SPRAY TO SINK

Mount hose guide assembly in far right hole in sink. Insert the spray hose down through hose guide and then up through second hole from left in sink.

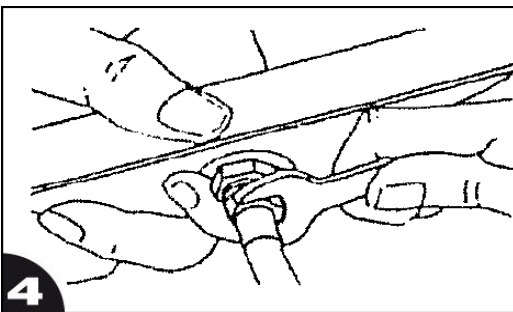

4 CONNECT SPRAY TO FAUCET

Attach spray hose connection to the center connection at bottom of faucet by using a wrench. Teflon tape may be used to seal threads.

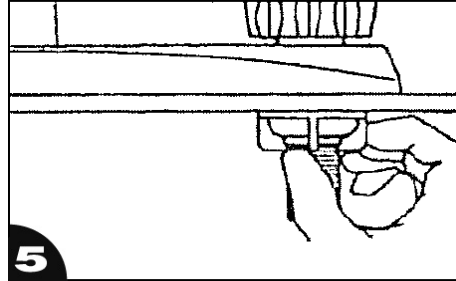

5 SECURE NEW FAUCET

Position the faucet on the sink. If the sink surface is uneven, a small amount of silicone sealant may be applied under the gasket. Screw locknuts onto faucet shanks and hand tighten.

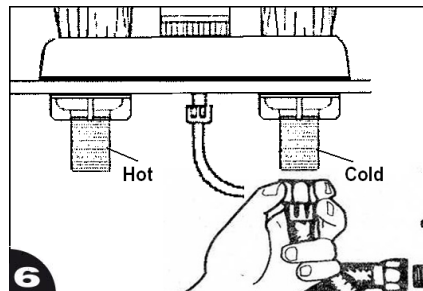

6 CONNECT WATER SUPPLY

Connect hot and cold water supplies and turn on the supply valves. Check all connections for leak. Retighten connections if necessary, but be careful not to over tighten.

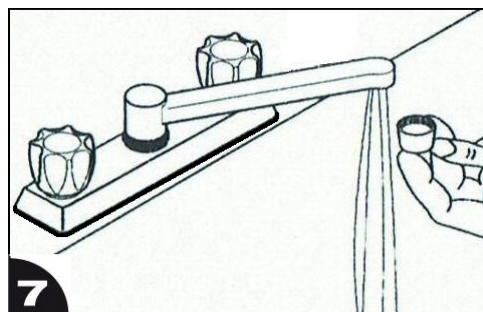

7 FLUSH WATER LINES

Remove the aerator from the spout tip. Turn the handle to the full on position. Run water for one minute. Repeat in hot and cold sides to remove debris that may have collected in the water lines. Reinstall the aerator.

Your new faucet is now ready to use!